

- Doorsnede A-A' -
1:100

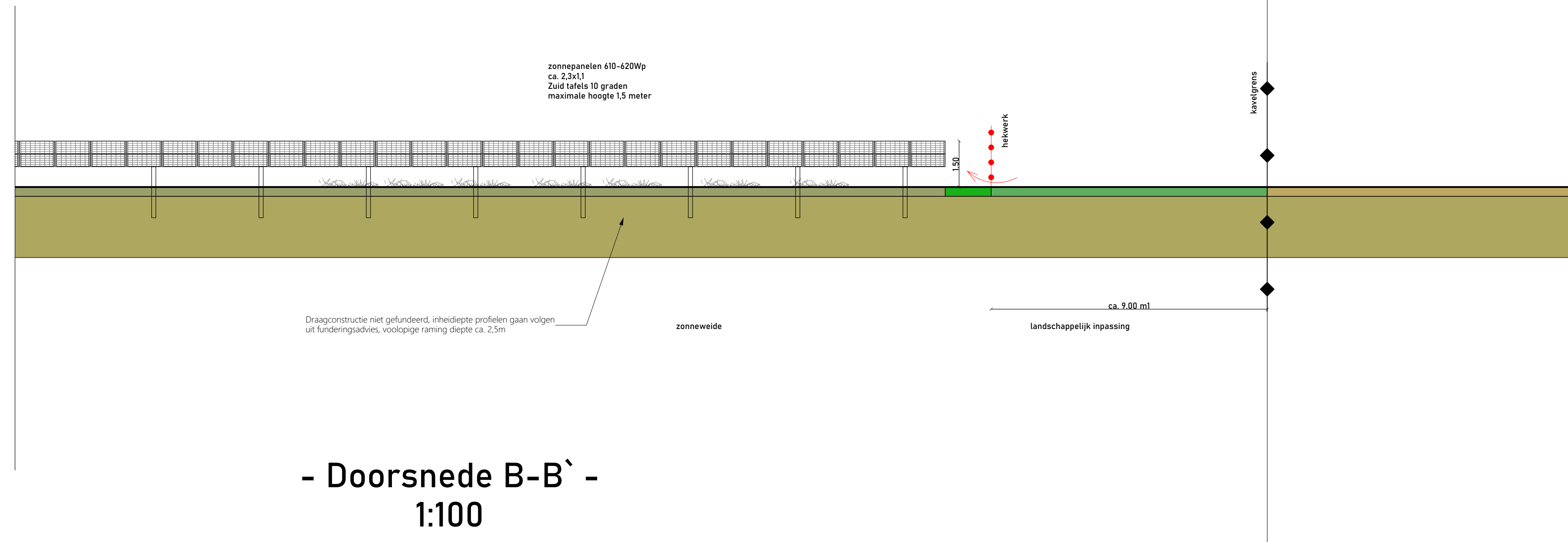

- Doorsnede B-B' -
1:100

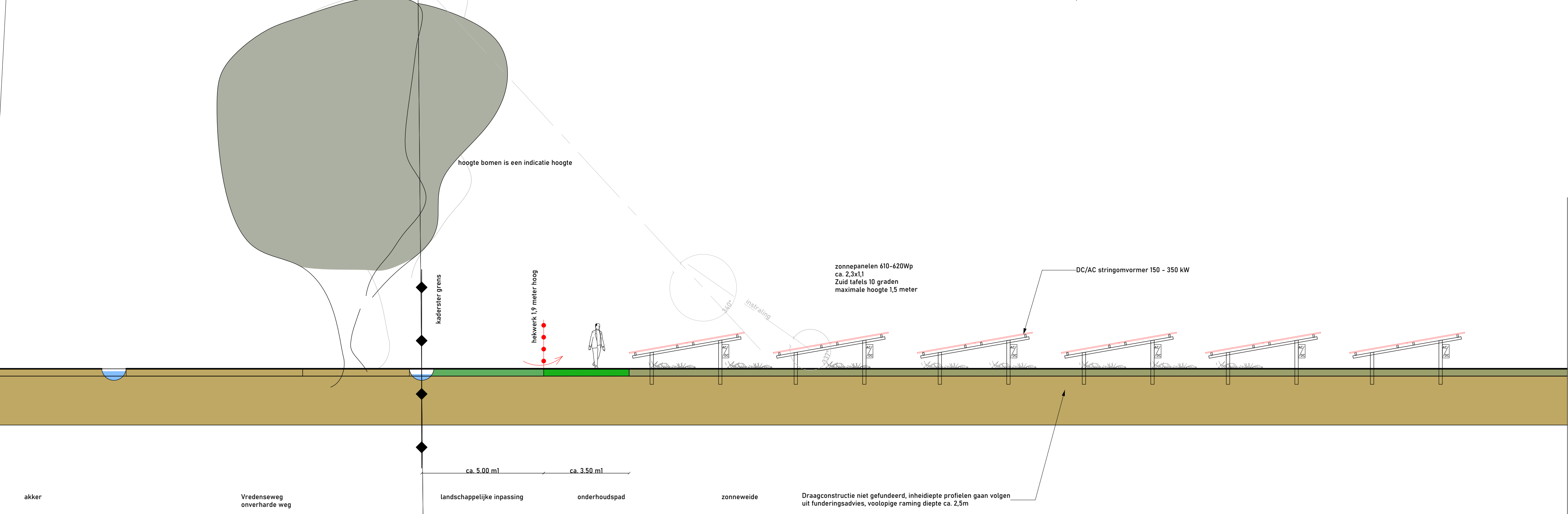

- Doorsnede C-C' -
1:100

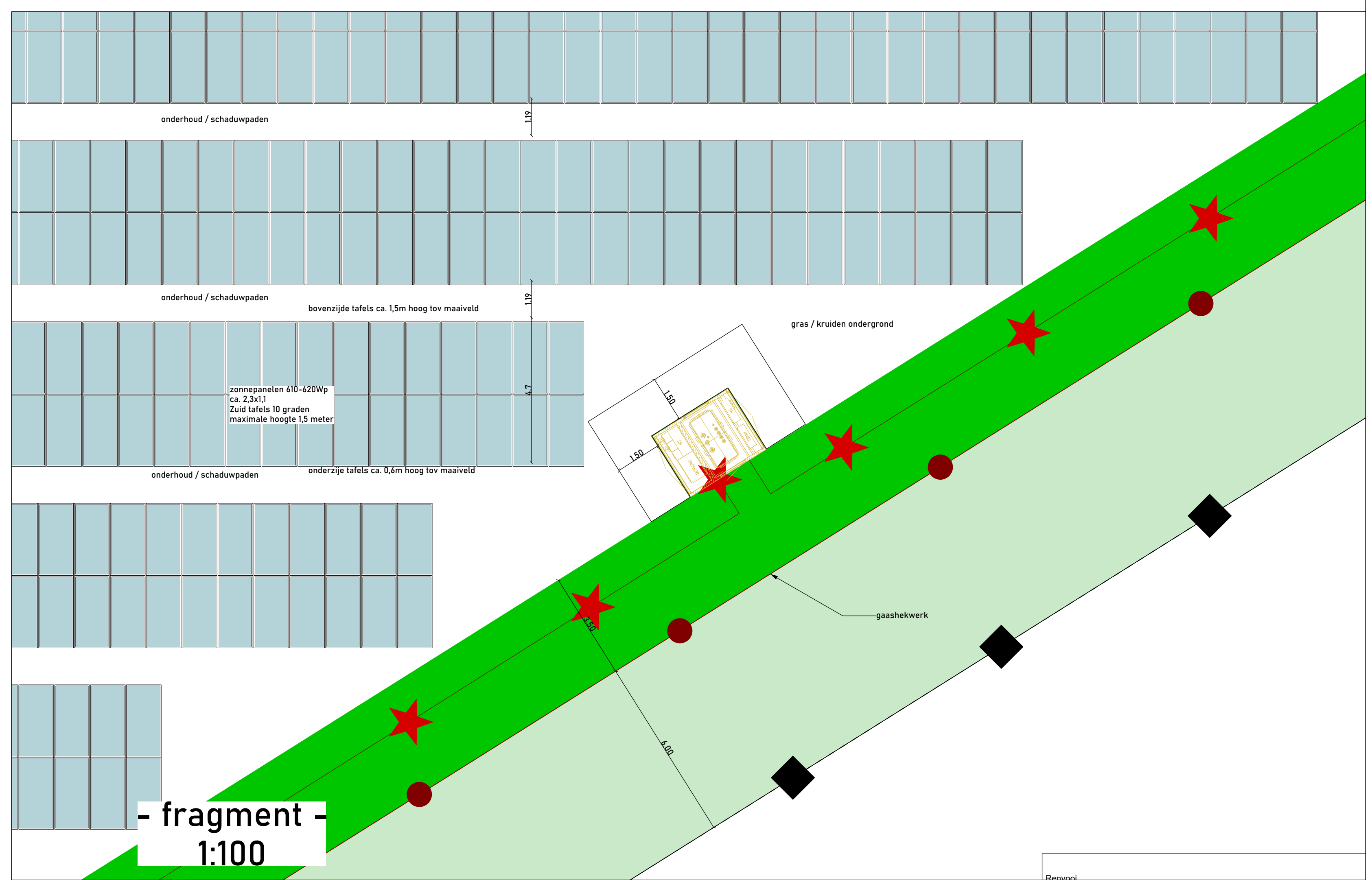

- fragment -
1:100

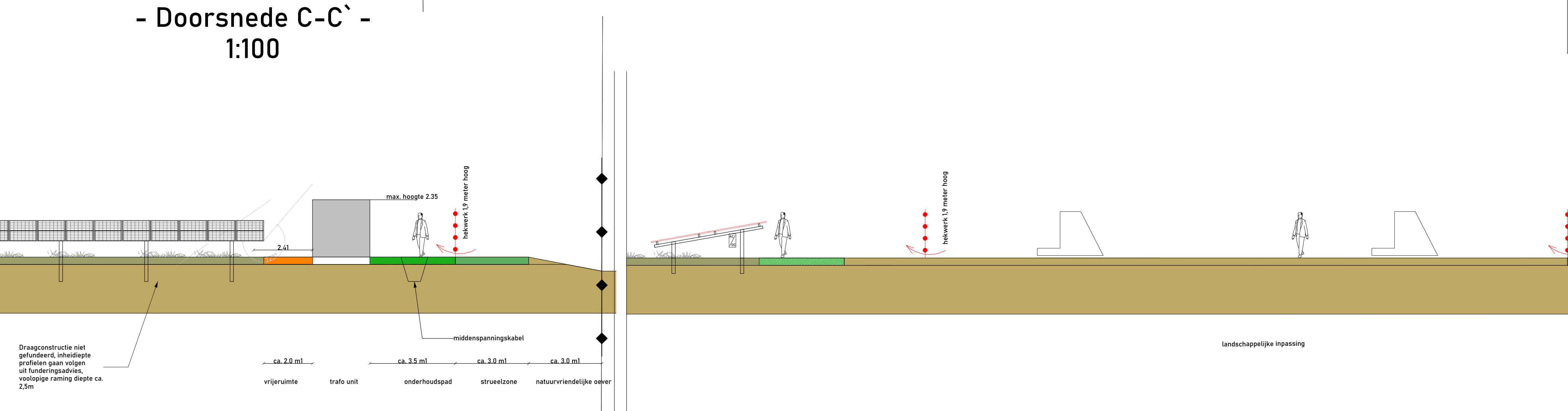

- Doorsnede D-D' -
1:100

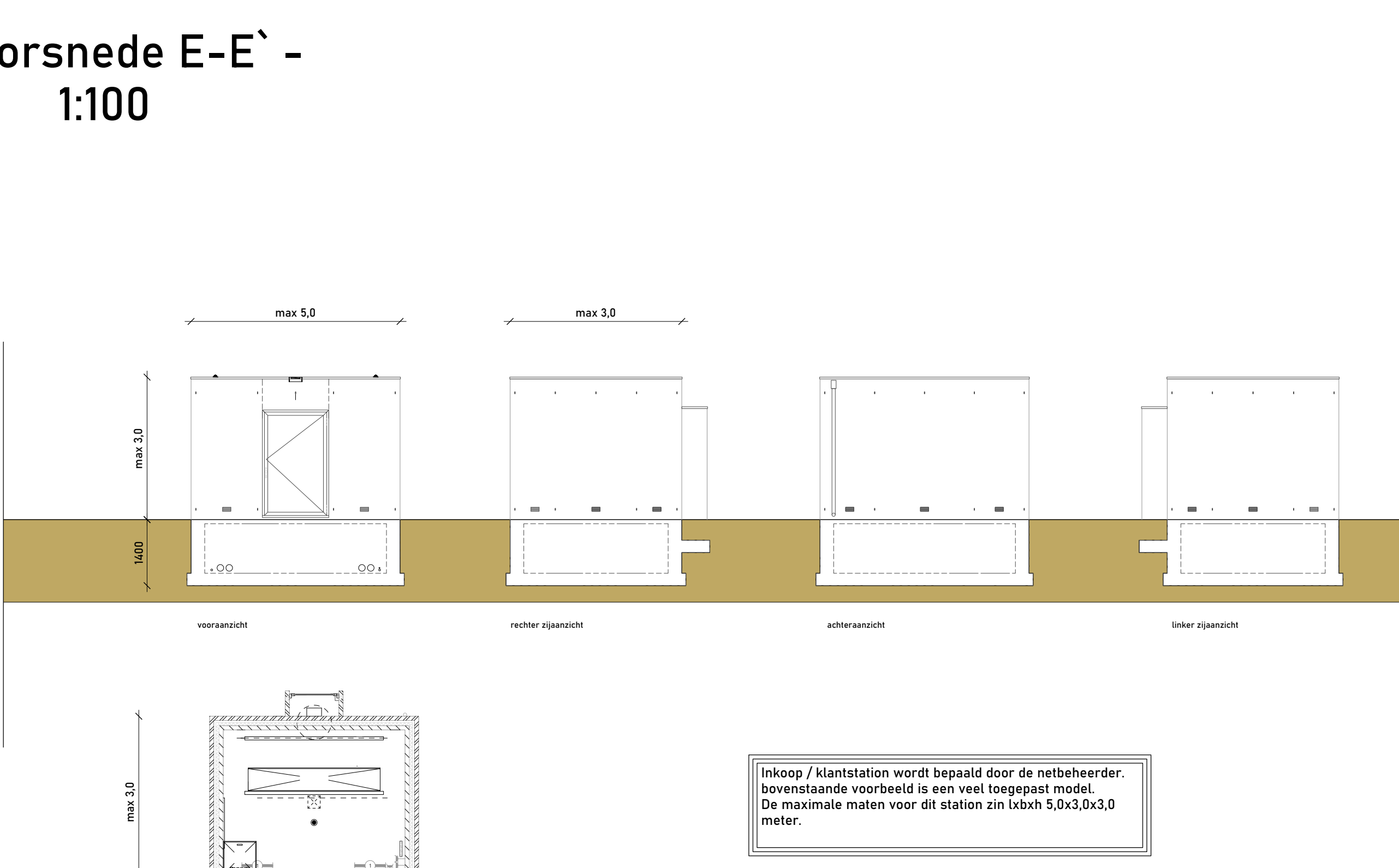

- Doorsnede E-E' -
1:100

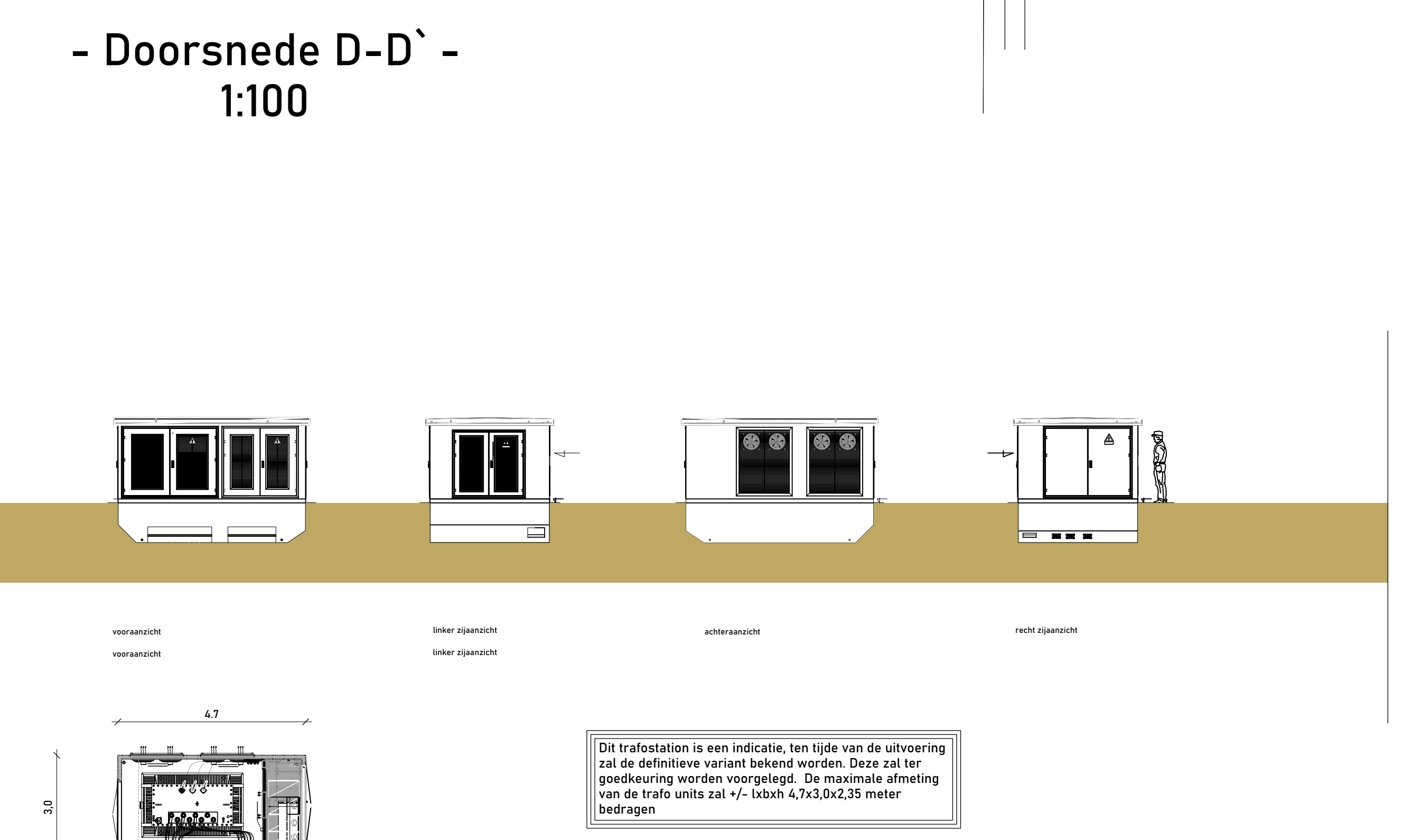

- trafostation -
1:100

- inkoop / klantstation -
1:100

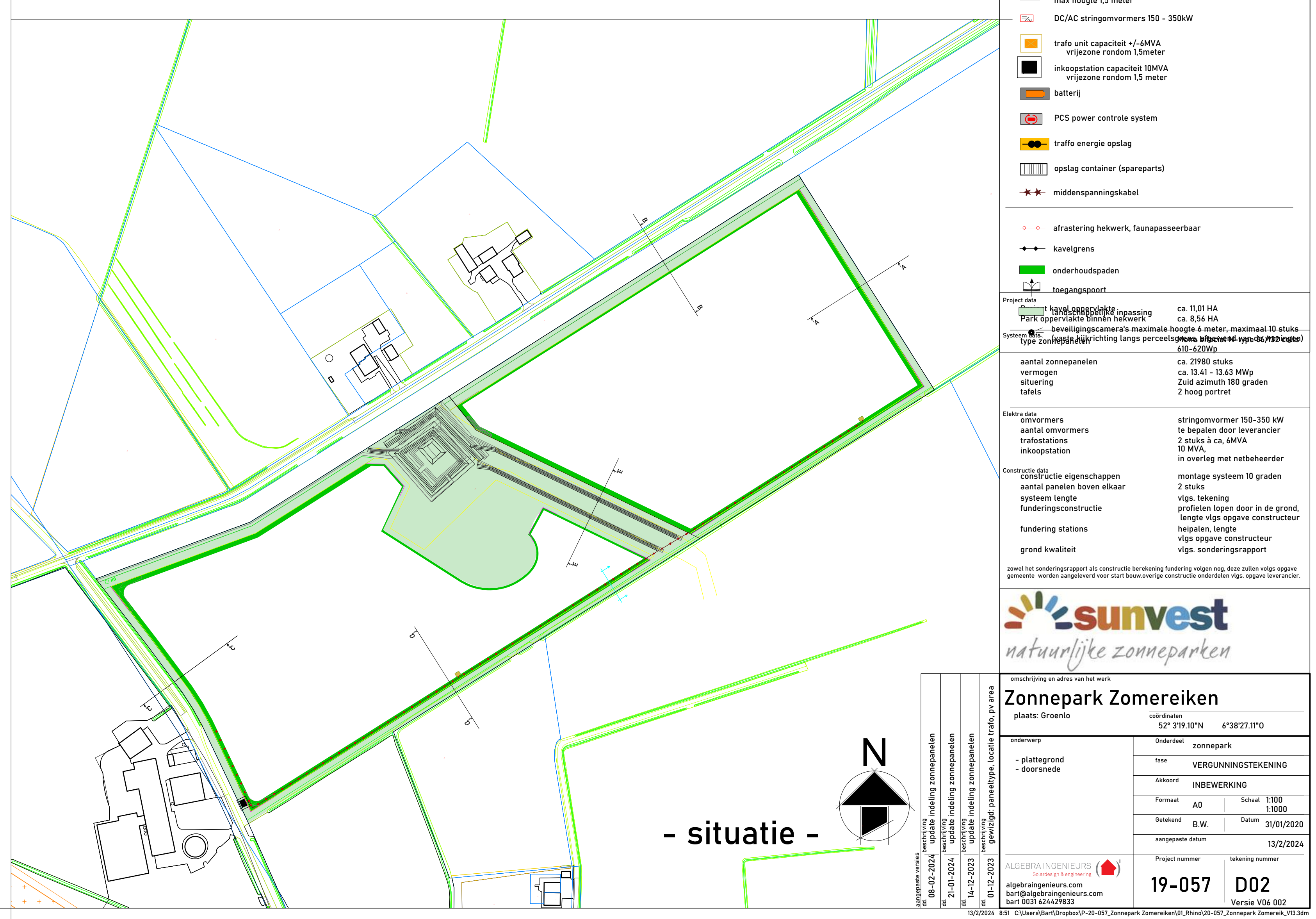

Legend:

- paneelveld 2x portret max hoogte 1,5 meter
- DC/AC stringomvormers 150 - 350kW
- trafo unit capaciteit +/- 4MVA vrijzone rondom 1,5meter
- inkoopstation capaciteit 10MVA vrijzone rondom 1,5 meter
- batterij
- PCS power control system
- trafo energie opslag
- opslag container (oparspart)
- middenspanningskabel
- afwatering hekkwerk, faunapasseerbaar
- kavelgrens
- onderhoudspaden
- laagspanningspoort

Project Data:

Projectnaam: Zonnepark Zomereiken
 Plaats: Groenlo
 Aantal zonnepanelen: ca. 2980 stuks
 Vermogen: ca. 13.41 - 13.43 MWp
 Afmeting: Zuid-zuidwest 180 graden tafels 2 hoog portret

Client: ALGERIA INGENIEURS
 Projectnummer: 19-057
 D02
 Versie: V04 003